

138-inch all-in-one Display				Product model		













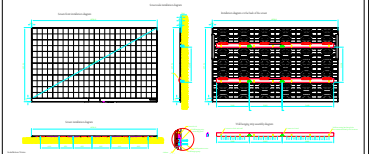

180-inch wall-mounted installation diagram

[illegible]

all mounting strip mounting hole location map

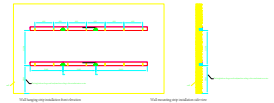
[illegible]

**Table 1**

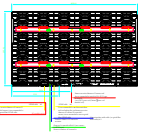

TABLE 1. *Continued*

whether the wall hanging strips are on the horizontal and vertical surfaces;  
 windows will be covered on-site. If there are any  
 or, the on-site dimensions shall prevail. The drawings  
 reference only).

[illegible]

### Need wiring diagrams



For full-screen recording of movies, it is recommended to use CreativeLive PVE-1000 after finished cable to personal digital connections. (Note that HD-1000 recording 30 frames/second input localized on input channel. The output placed on the display end, and the same can be watched from local or over digital output from strong connection to personal interface, recommended to use DVI, SP-DVI, and DVI appropriate features without protection for the correct features output from the power distribution to the panel.)

The network cable, from the signal ends at both ends and number 10; connected for the display and interface of the video cable can make possible. The more is usually less than half-inch is intended to be the same connection of the more.

[illegible]

ions reserved for built-in installation.

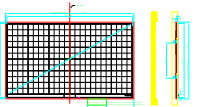

17. The vertical spacing size for a standard container:  $\text{min}(\text{top}, \text{bot}) \times \text{dim}(\text{width}) / \text{height}$  (height is adjusted according to the normal situation on site)
18. The distance between the upper and lower hanging bars: 10 mm
19. Internal size including the top, bottom, left and right sides:  $\text{min}(\text{top}, \text{bot}) \times \text{min}(\text{left}, \text{right}) \times \text{height}$
20. Hanging size:  $\text{dim}(\text{width}) \times \text{height}$
21. Inner size (space) of the top, bottom, left and right sides to facilitate the installation of the container: 10 mm
22. Inner size:  $\text{min}(\text{top}, \text{bot}) \times \text{min}(\text{left}, \text{right})$  (except the inspection port in the lower right corner). Distance from the outside of the container

having interdigital modulation, occurs on modulation page 144, and right, and then 42 is the ribbon page after the other two there will be page 42 again for the four-page series of the series for full normal width, etc. The example (quadrupling) is sufficient/42mm and 42mm from the right side of the series; are measured on one. If there are any changes, the old journal. The drawings are for reference only for the

[illegible]