

# HUANUO

## Monitors Desk Mount Instruction Manual

V3.0

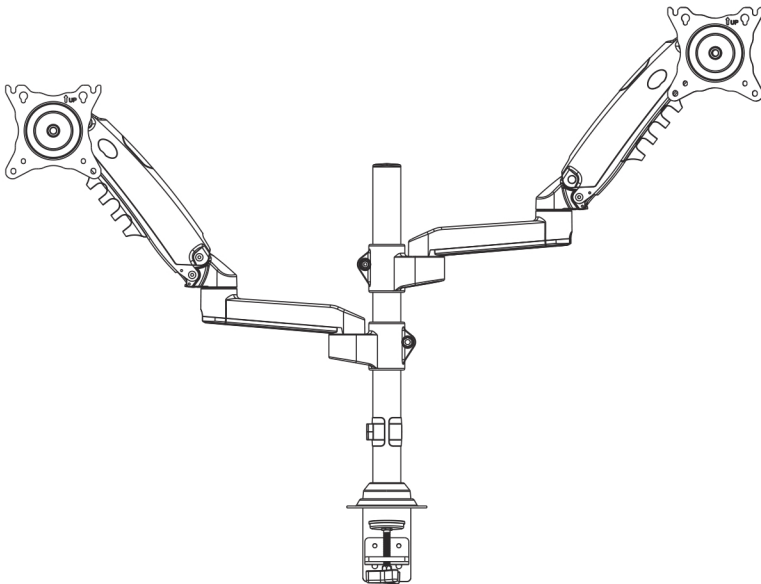

**Model: HNDS8**

For any parts enquiries, please contact AV Supply Group as below:  
New Zealand P 64 9 274 9172 E [info@avsupply.co.nz](mailto:info@avsupply.co.nz)  
Australia P 61 3 9071 4585 E [info@avsupplygroup.com.au](mailto:info@avsupplygroup.com.au)

## IMPORTANT SAFETY INFORMATION

Please carefully read all instructions before attempting installation. If you do not understand the instructions or have any concerns or questions, please contact our customer service at [support@huanuoav.com](mailto:support@huanuoav.com).

**CAUTION:** Avoid potential personal injuries and property damage!

- Do not use this product for any purpose that is not explicitly specified in this manual. Do not exceed weight capacity. We are not liable for damage or injury caused by improper mounting, incorrect assembly or inappropriate use.
- This product contains a high pressure gas spring, fire and percussion prohibited. Also it is strictly prohibited to dismantle without professionals. Please return to the manufacturer or hand over to professional agencies if the product is abandoned.
- The desk must be capable of supporting three times the weight of the total load (the mount, the monitor and all accessories weight). Don't use the product on particle board.

## Weight Restrictions



Your monitor (including accessories) **CANNOT EXCEED** 4.4-19.8lbs (2-9 kg)

### **WARNING**

**DO NOT** exceed the maximum weight indicated. This mounting system is intended for use only within the maximum weights indicated. Use with products heavier than the maximum weights indicated may result in failure of the mount and its accessories, causing possible damage and or injury.

If your monitor weighs more, this mount is **NOT** compatible.

## Check the VESA Pattern of Your Monitor before You Begin the Installation

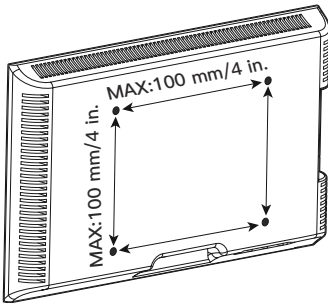

75 mm  $\approx$  3 in.  
100 mm  $\approx$  4 in.

**Minimum VESA pattern:**  
75mm/3 in.(W)x75mm/3 in.(H)

If your Monitor VESA is greater than 100x100 mm/4x4 in. or less than VESA 75x75mm/3x3in., this mount is **NOT** compatible.

If this desk mount is **NOT** compatible, please contact customer service at [support@huanuoav.com](mailto:support@huanuoav.com) to find a compatible product.

# Product Features

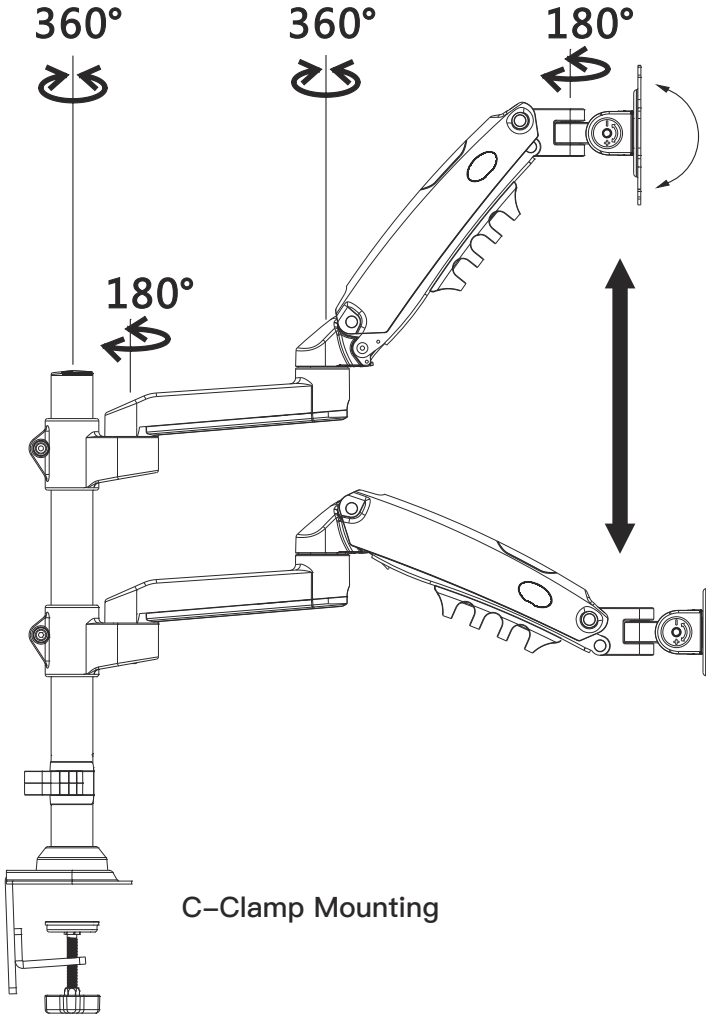

TENSION ADJUSTMENT SHOULD BE DONE ONLY  
AFTER MOUNT INSTALLATION



Do not adjust tension without monitor.

1. Ensure monitor has been attached to the mount.
2. Read your monitor box or manual to find out monitor net weight.
3. Ensure the net weight of monitor (including accessories) is between 4.4~19.8 lbs (2~9 kg).



Clockwise to reduce  
tension(carry less weight)

Counter-clockwise to increase  
tension(carry more weight)

Warning!

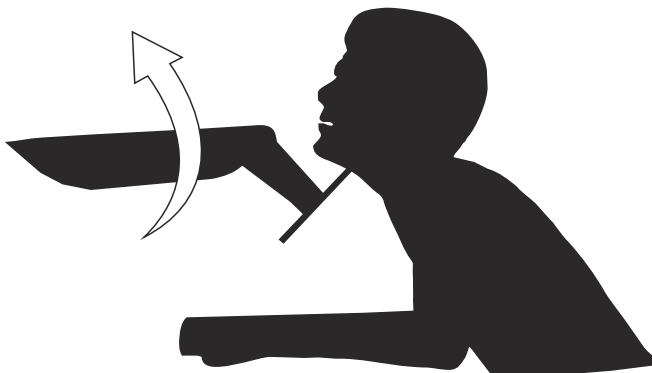

## Tools Needed (Not Included)



Screwdriver

## Supplied Parts and Hardware

**⚠ Warning:** This product contains small items that could be a choking hazard if swallowed.

Before starting assembly, verify all parts are included and undamaged. Do not use damaged or defective parts. If you require replacement parts, contact our customer service at [support@huanuoav.com](mailto:support@huanuoav.com).

- Please note: Not all hardware included in this package will be used.

## Supplied Parts and Hardware for Step 1

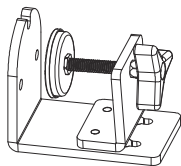

**02** C-Clamp X1

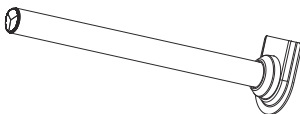

**03** Pole Assembly X1

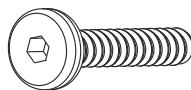

Bolt(C)  
M6x12mm (3pcs)



**(D)** M8  
Butterfly Nut

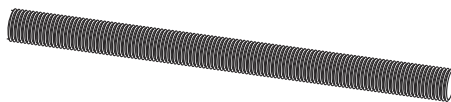

**(D)** M8x120mm  
Grommet Bolt



**(E)**  
Locking Plate



**(F)**  
5/32 in.(4mm)  
Allen Key

## Supplied Parts and Hardware for Step 2

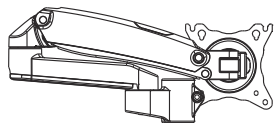

**01** Arm X2



**05** Cable Clip X2



**(F)**  
5/32 in.(4mm)  
Allen Key

## Supplied Parts and Hardware for Step 3

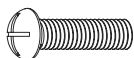

Bolt (A)  
M4x12mm (8pcs)

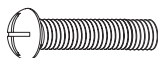

Bolt (B-1)  
M4x16mm (8pcs)



Spacer (B-2)  
5mm (8pcs)

## Supplied Hardware for Step 4 and Step 6



**(F)**  
13/64 in.(5mm)  
Allen Key

## Supplied Parts and Hardware for Step 8



**04** Cable Cover X2



Bolt (G)  
M4x6mm (4pcs)

# Step 1 Install the Base

## A. For Clamp Mounting

### A-1 Install the C-Clamp

**Warning:**  Ensure bolts are secured firmly.

② Connect part [X] to pole assembly [03]

① Detach the c-clamp entirely

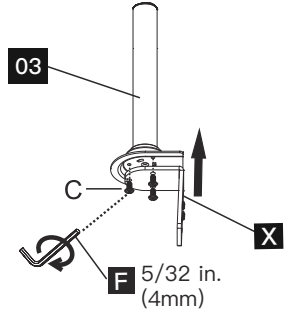
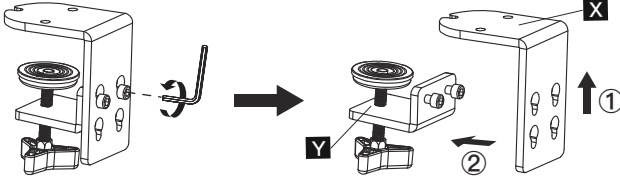

③ Connect part [Y] to part [X] according to the thickness of the desktop

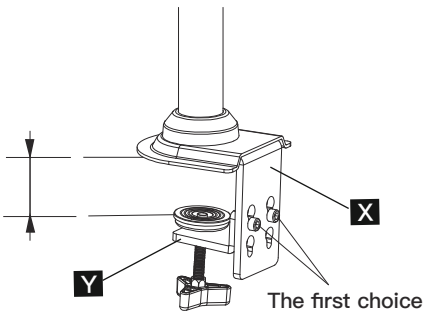

OR

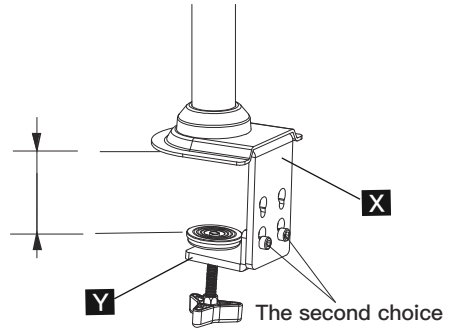

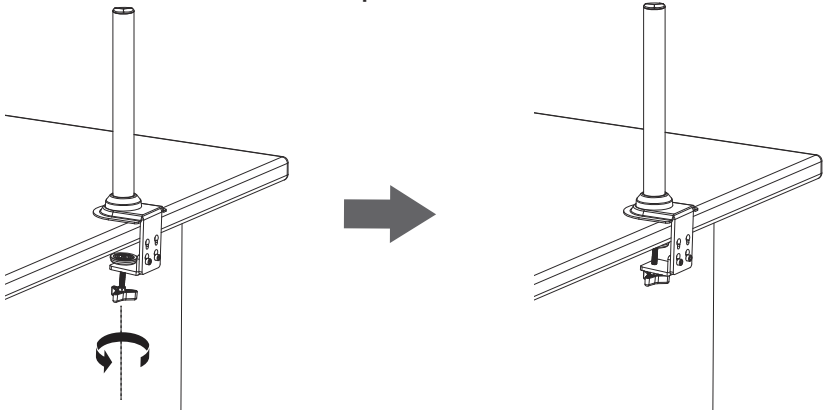

④ Secure the base to the desktop

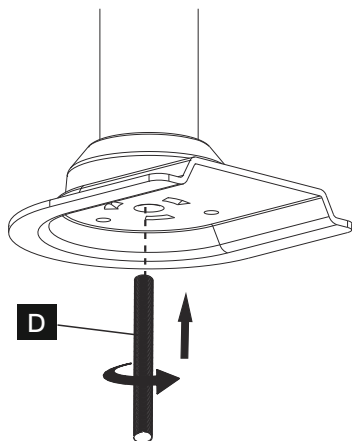

## B. For Grommet Mounting

### ① Install the grommet bolt



**Warning:**   
Ensure bolts are secured firmly.

### ② Secure the base to desktop using locking plate [E] and butterfly nut [D]

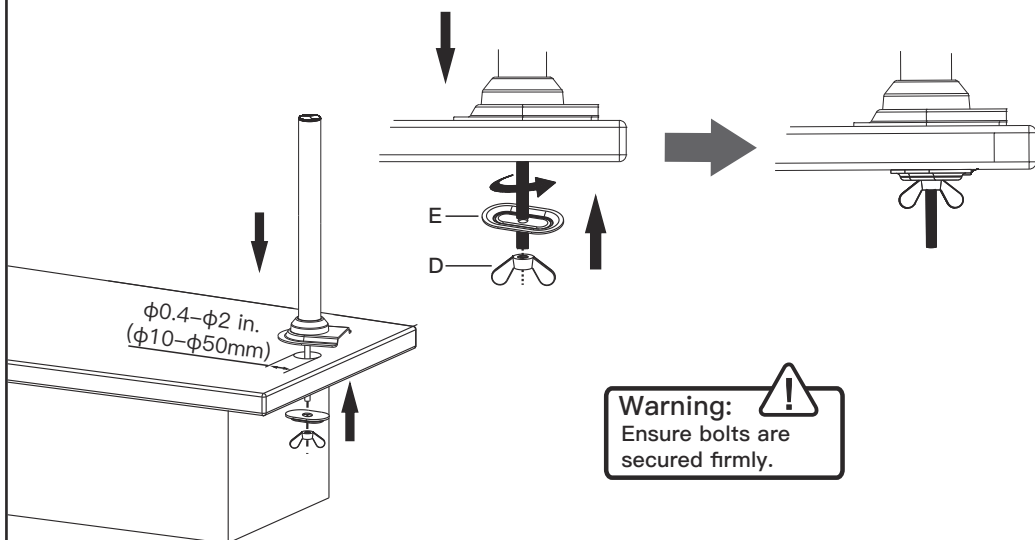

**Warning:**   
Ensure bolts are secured firmly.



## Step 2 Install the Arms

- 1 Slide the cable clip [05] to the pole assembly [03]

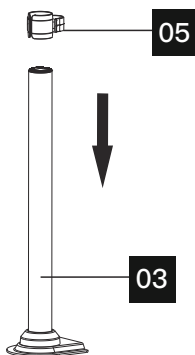

- 2 Slide arm [01] to the pole assembly [03]

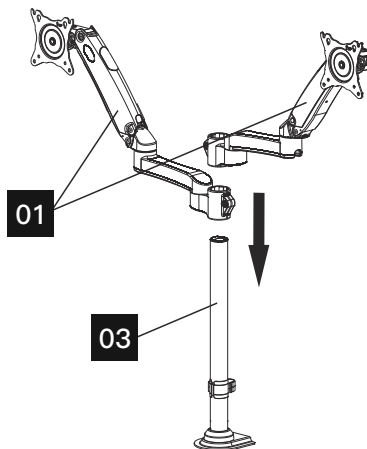

- 3 Secure the arm [01] to the pole assembly [03] by tightening the preassemble bolts on the arms [01]

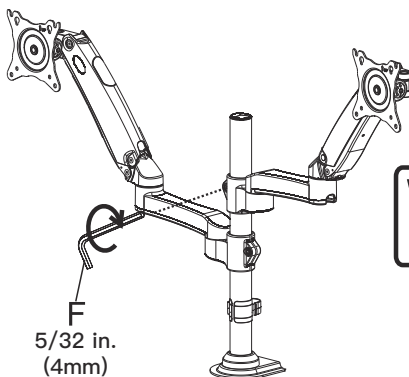

**Warning:**   
Ensure bolts are secured firmly.

## Step 3 Attach Monitors to the Arms

### 3-1 Choose Proper bolts

Flat back monitor

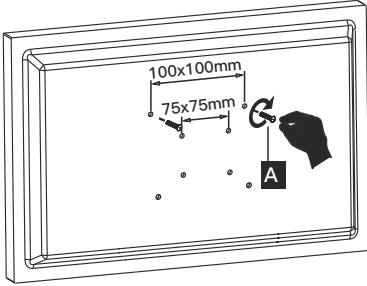

Round back monitor

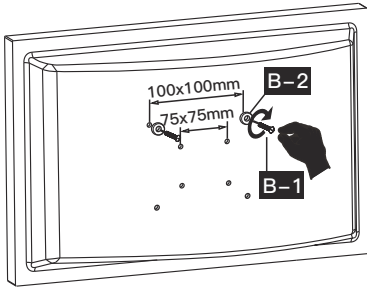

### 3-2 Install Monitors to the Arms

① 0.1-0.2in.(3-5mm) spacing left

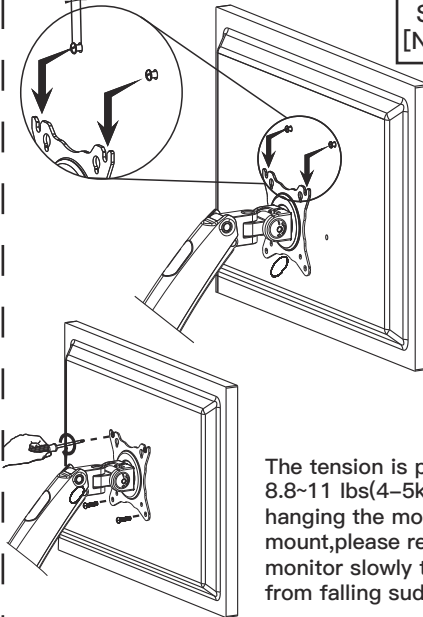

  
Screwdriver  
[Not Included]

The tension is preset at 8.8~11 lbs(4~5kg). After hanging the monitor to the mount, please release the monitor slowly to prevent it from falling suddenly.

## Step 4 Adjust Gas Spring Tension

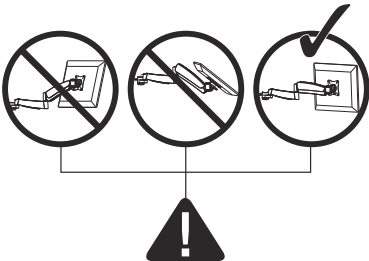

Be sure to keep the arm in horizontal position during adjustment. Or else, it will be difficult to adjust the mount or possibly damage the mount.

1. If the monitor can stay at the desired height by itself, no adjustment needed.
2. If the monitor rises up, press the arm to keep it in horizontal position and then use the 13/64 in.(5mm) Alley key (F) to turn the bolts clockwise(“-” direction) to reduce tension of the arm only until the monitor can stay at the desired height by itself.
3. If the monitor falls down, lift the arm to keep it in horizontal position and then use the 13/64 in.(5mm) Alley key (F) to turn the bolts counter-clock-wise(“+” direction) to increase tension of the arm only until the monitor can stay at the desired height by itself.

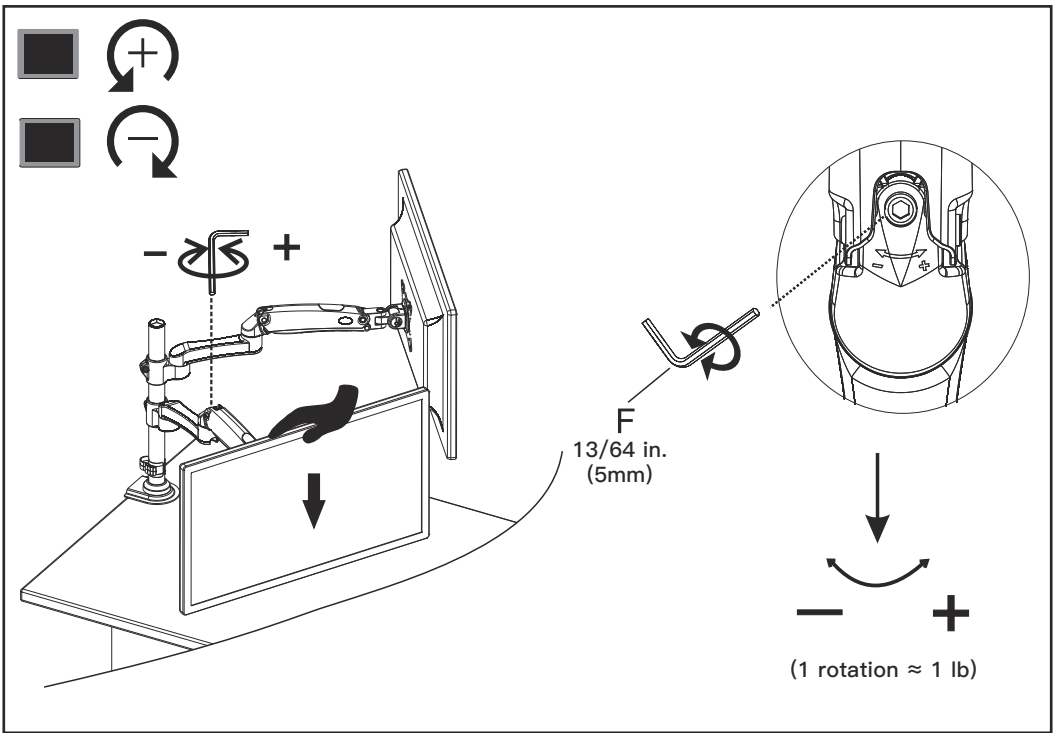

## Step 5 Rotation Restriction

Proper usage directions

Non-proper usage directions

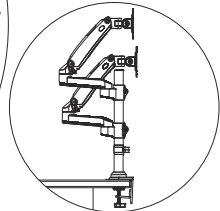
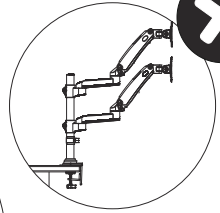
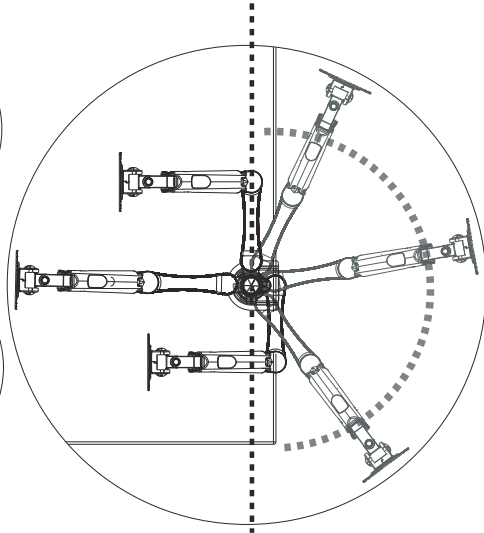
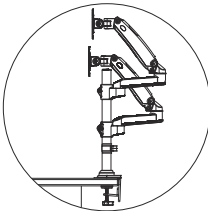
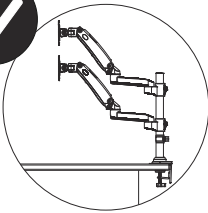

## Step 6 Tilt Adjustment

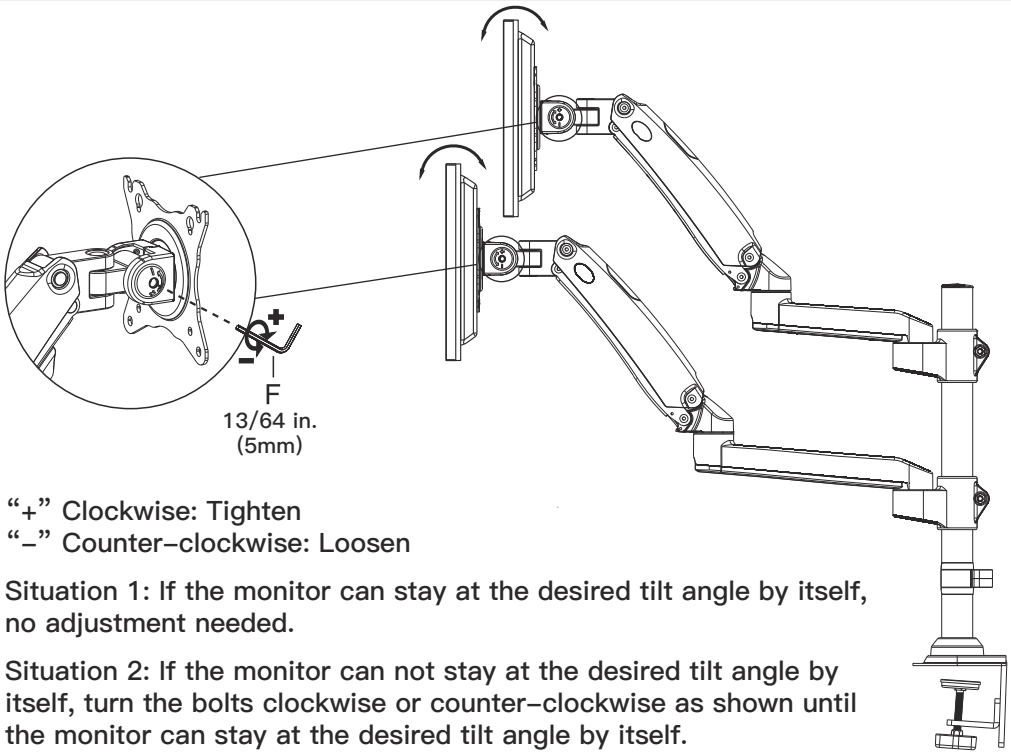

## Step 7 Rotation Adjustment

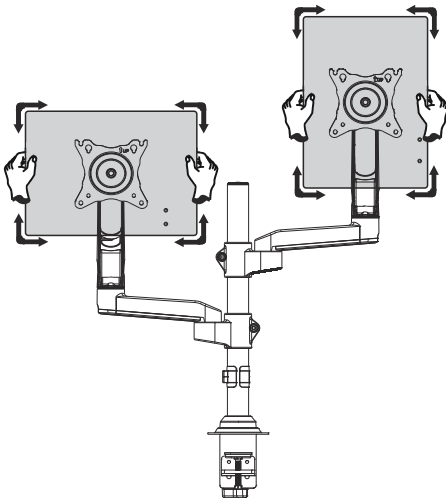

**360°  
Rotation**

Only suitable for the monitors with the center of gravity in the center position

# Step 8 Route Cables along the Arms

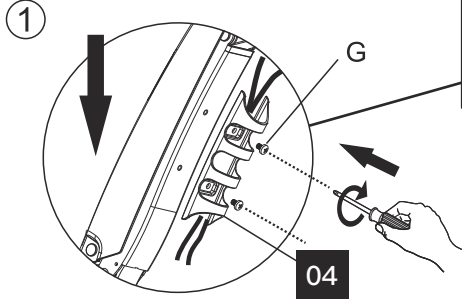
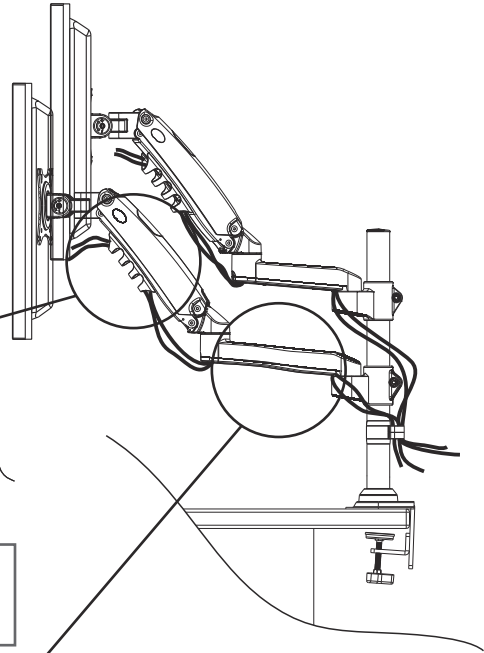

Secure the Cable Cover [04] to the arm [01] by tightening the bolts [G] using screwdriver

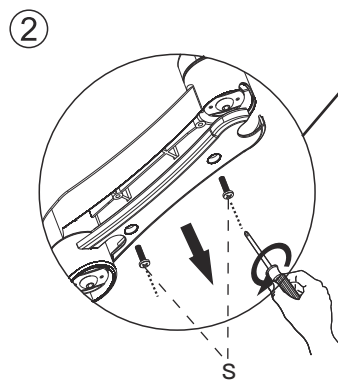

Loosen the preassembled bolts [S] on the arm [01] to detach the cable guide from the arm [01], and keep the bolt for the use in next step

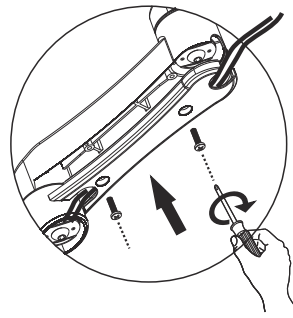

Route the cables into the cable guide and secure the cable guide by tightening the bolts [S] using screwdriver