

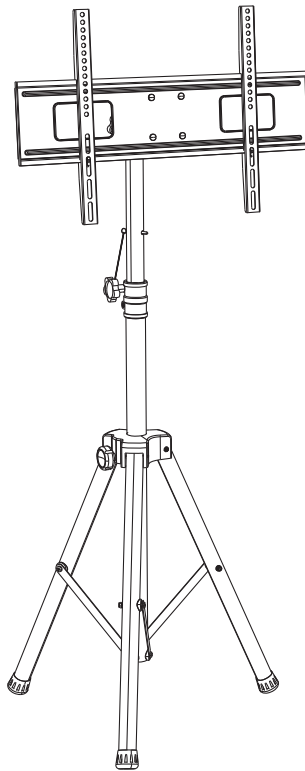

PERLESMITH

TV Tripod Stand Instruction Manual

V1.0



Model:PSTM2



Website:
www.perlesmith.com

Thank you for choosing this Perlesmith product! At Perlesmith we strive to provide you with the best quality products and services in the industry. Please share your experience of our product with others at www.perlesmith.com/pages/reviews if you are satisfied. Should you have any issues, please don't hesitate to contact us.

Technical Support:
1-800-556-6806 Mon-Fri 10am – 5pm (PST) (USA) (CAN)
Other Info:
supportus@perlesmith.com (US/CA/DE/UK/FR/IT/ES/AU)

Important Safety Instructions

- Check to assure that all components were received undamaged. Do not use damaged or defective parts. If you require replacement parts, contact customer service at supportus@perlesmith.com.
- Install and operate this product with care. Please read this instruction before beginning the installation, and carefully follow all instructions contained herein. Use proper tools during installation.
- If you do not understand the instructions or have any concerns or questions, please contact customer service at supportus@perlesmith.com.
- Do not use this product for any purpose that is not explicitly specified in this manual. Do not exceed weight capacity. We cannot be liable for damage or injury caused by improper mounting, incorrect assembly or inappropriate use.

TIP OVER WARNING

SERIOUS OR FATAL CRUSHING INJURIES CAN OCCUR FROM TIP OVER. TO HELP PREVENT TIP OVER:

- NEVER ALLOW CHILDREN TO CLIMB, STAND, HANG, OR PLAY ON ANY PART OF TV OR TV STAND.
- USE TIP OVER RESTRAINT OR ANCHOR STAND TO WALL. USE OF TIP OVER RESTRAINTS MAY ONLY REDUCE, BUT NOT ELIMINATE RISK OF TIP OVER.

Check the VESA Pattern of TV before the Installation

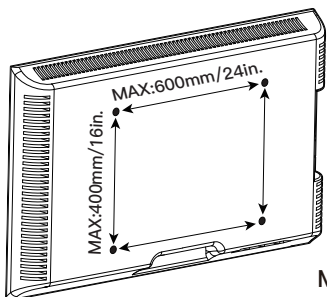

100mm	≈ 4in.
200mm	≈ 7 7/8in.
300mm	≈ 11 3/4in.
400mm	≈ 15 3/4in.
600mm	≈ 23 6/10 in.

Minimum VESA pattern: 200mm/8 in.(W)x100mm/4in.(H)

If your TV VESA is greater than 600x400 mm/24x16 in. or less than VESA 100x100mm/4x4in., this TV tripod stand is NOT compatible.

If this TV tripod stand is NOT compatible, please contact customer service at supportus@perlesmith.com to find a compatible product.

Parts List

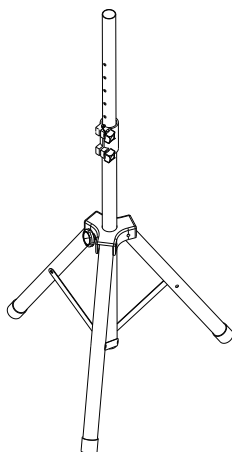

I (x1)
Pole Assembly

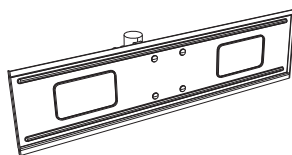

J (x1)
Head Assembly with TV Plate

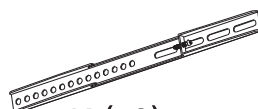

K (x2)
TV Bracket

Hardware List

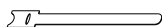

Cable Tie
L(x3)



Allen Key
M(x1)



Wrench
N(x1)



M4x30mm Bolt
A(x4)



M6x15mm Bolt
B(x4)



M6x30mm Bolt
C(x4)



M8x15mm Bolt
D(x4)



M8x50mm Bolt
E(x4)



Washer with 3 Holes
F(x4)



φ8.5x18x5mm Spacer
G(x8)



φ8.5x18x10mm Spacer
H(x8)

STEP 1 Adjust the Height of Pole

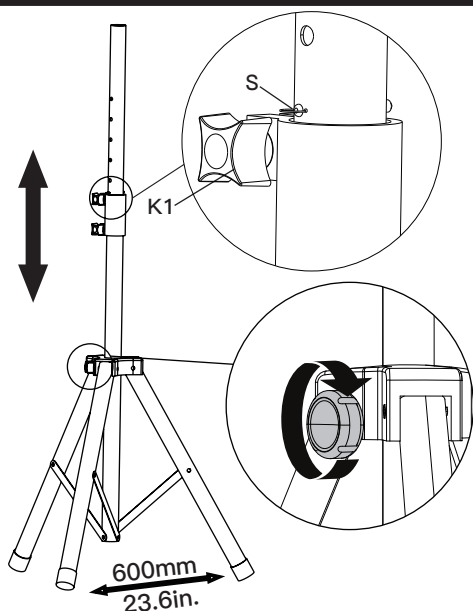

Warning:

After adjusting the pole to desired height, insert the latch [S] to the holes on the upper pole. Fasten the knob [K1] to hold upper pole.

CAUTION:

DISTANCE BETWEEN EACH FOOT MUST BE 600mm/23.6in.

1. Loosen the lower knob.
2. Adjust the distance between each feet to be 600mm/23.6in.
3. Tighten the lower knob

CAUTION: TO AVOID ANY INJURIES, PLEASE TAKE OFF TV SET BEFORE MAKING HEIGHT ADJUSTMENT

STEP 2 Secure the Head Assembly with TV Plate to Pole Assembly

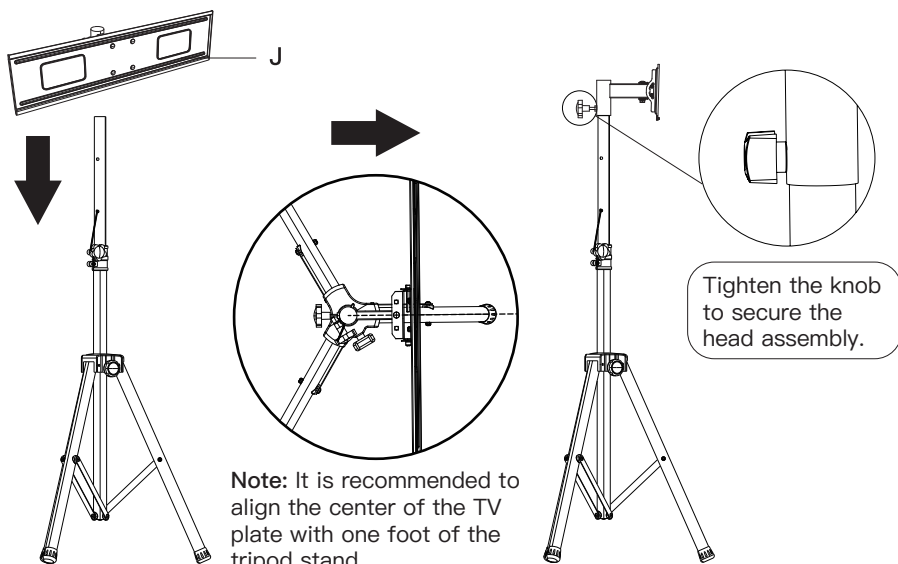

Tighten the knob to secure the head assembly.

Note: It is recommended to align the center of the TV plate with one foot of the tripod stand

STEP 3 Secure the TV Brackets to Your TV

FLAT BACK TV (UNIVERSAL TV PLATE)

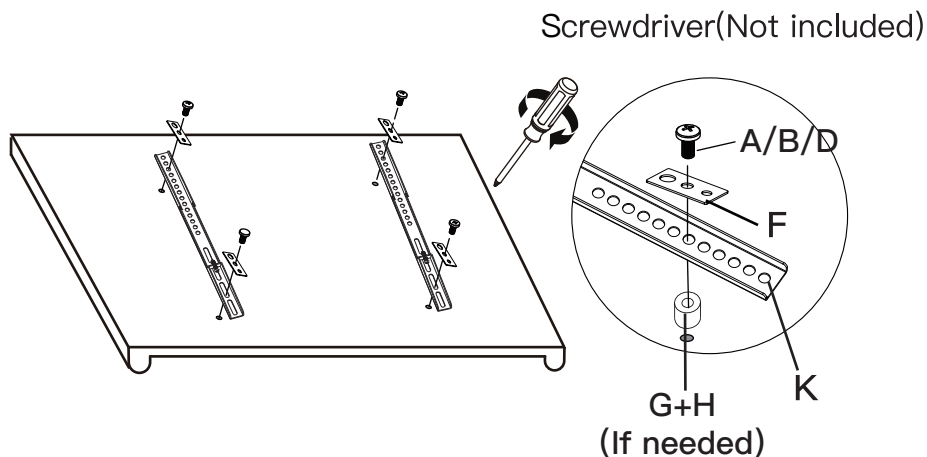

ROUND BACK TV (UNIVERSAL TV PLATE)

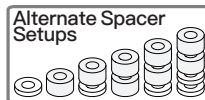
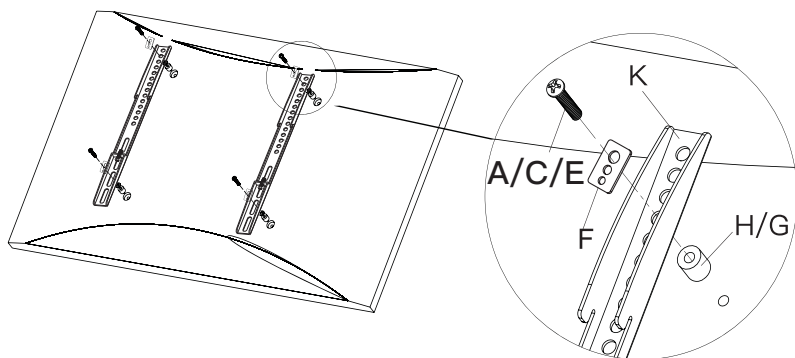

First, make sure the diameter of the bolt(A-E) fits your TV. Then, please see the diagram above. You will need to thread the bolts into the TV using the correct washers(F) and spacers (G or H) if necessary with a screwdriver(Not included). Please make sure the TV brackets(K) are vertically centered and level with each other.

STEP 4 Secure the TV onto the Plate

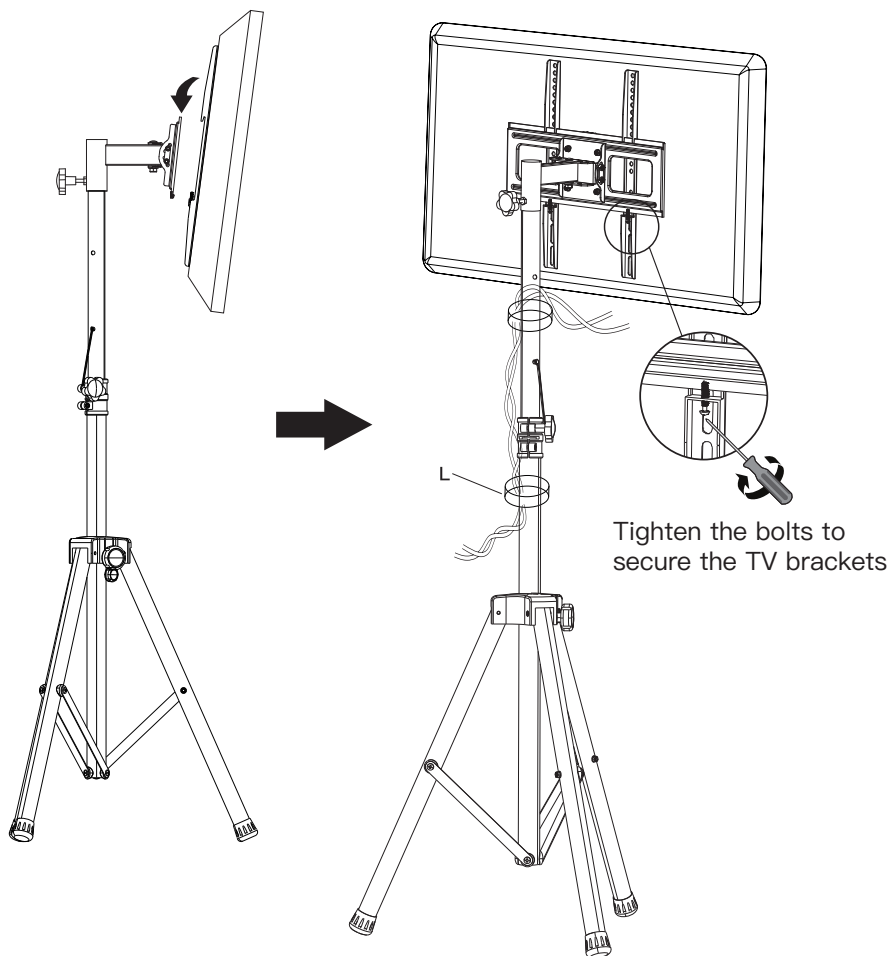

You may need assistance with this step.

STEP 5 Adjust Level and Tilt Angles

Warning: Do not over-loosen the nuts or bolts to prevent the TV from falling down.

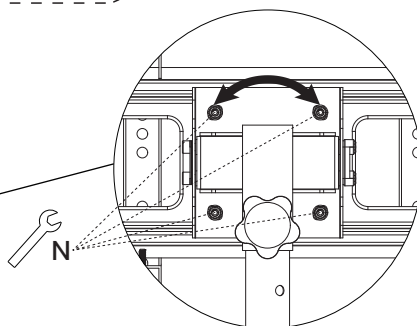
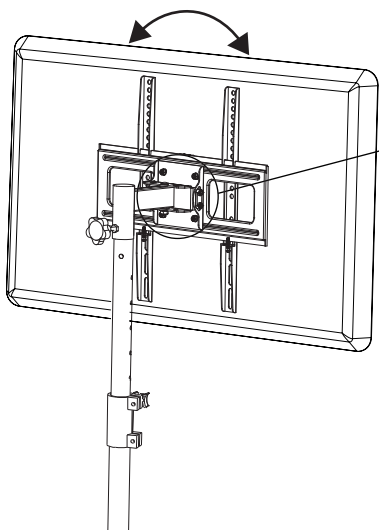

Level Adjustment

1. Loosen the four nuts [N].
2. Level your TV.
3. Retighten both nuts [N] to hold TV in place.

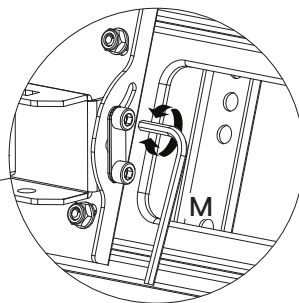
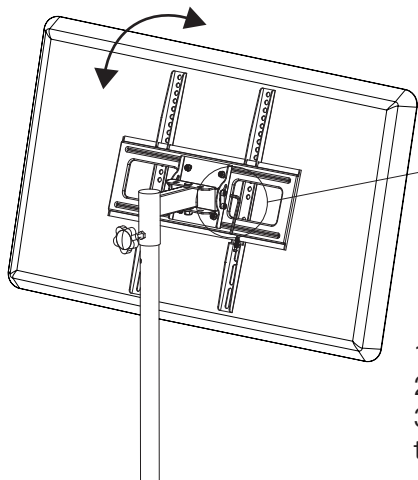

Tilt Adjustment

1. Loosen the two level bolts.
2. Adjust the TV to the desired tilting angle.
3. Fasten the bolts to hold the tilting angle of the TV.

STEP 6 Manage the Cables

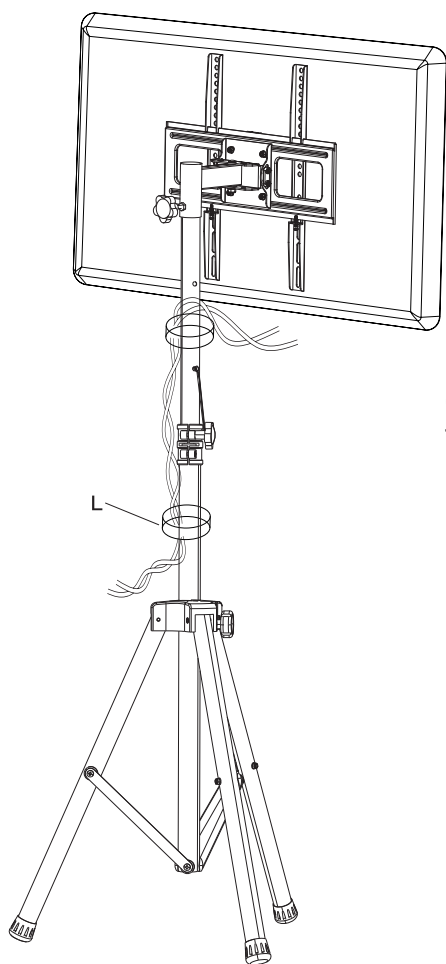

Cable organizers [L] are used
for cables management