

MEDIUM TILTING TV WALL MOUNT

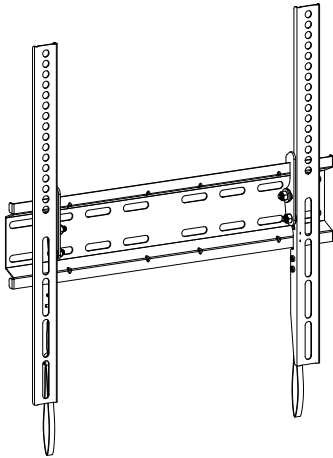

for most 23" to 55" TVs  
up to **115 lbs**



For any parts enquiries, please contact AV Supply Group as below:  
New Zealand: P 64 9 274 9172 E [info@avsupply.co.nz](mailto:info@avsupply.co.nz)  
Australia: P 61 3 9071 4585 E [info@avsupplygroup.com.au](mailto:info@avsupplygroup.com.au)

Model: PSMTK1

STEP 1 Check the VESA pattern of your TV

Measure the distance between the holes located at the back of your TV (these measures may form the shape of a square, or a rectangle) and check that these taken measures are within the VESA(\*) range for this wall mount.  
(\*) VESA: International standard established by the TV manufacturers used to determine if LCD / LED TVs are compatible with wall mounts.

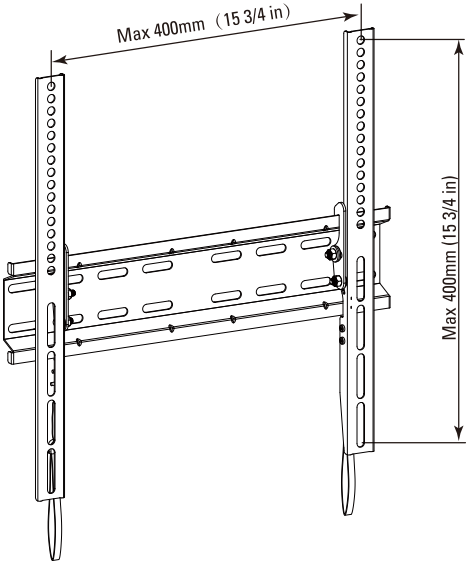
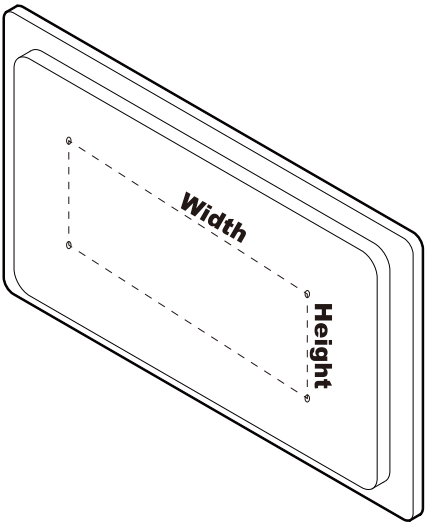

- 75 mm ≈ 2 7/8 in
- 100 mm ≈ 4 in
- 200 mm ≈ 7 7/8 in
- 300 mm ≈ 11 3/4 in
- 400 mm ≈ 15 3/4 in
- 600 mm ≈ 23 5/8 in

WARNING

- \* **WARNING! SEVERE PERSONAL INJURY AND PROPERTY DAMAGE CAN RESULT FROM IMPROPER INSTALLATION OR ASSEMBLY. READ THE FOLLOWING WARNINGS BEFORE BEGINNING.**
- \* If you do not understand the instructions or have any concerns or questions, please contact a qualified installaer.
- \* Do not install or assemble if the product or hardware is damaged or missing. Not all parts and hardware included must be used. For any parts enquiries, please contact AV Supply Group as below:New Zealand: P 64 9 274 9172 E [info@avsupply.co.nz](mailto:info@avsupply.co.nz) Australia: P 61 3 9071 4585 E [info@avsupplygroup.com.au](mailto:info@avsupplygroup.com.au)
- \* This product has been designed for use on a vertical wall constructed of wood studs. Wood studs being defined as a wall consisting of a minimum of 2" x 4" studs with a maximum of 16" stud spacing with a maximum of 1/2" of wall covering (drywall, lath, plaster).For custom installations please contact a qualified installer. For safe installation, the wall you are mounting to must support 4 times the weight of the total load. If not, the surface must be reinforced to meet this standard. The installer is responsible for verifying that the wall structure/surface will safely support the total load.
- \* This product may contain moving parts. Use with caution.
- \* **DO NOT EXCEED THE MAXIMUM WEIGHT CAPACITY FOR THIS PRODUCT.**
- \* Please check [www.perlesmith.com](http://www.perlesmith.com) for more products and company information.

WEIGHT CAPACITY



CAUTION!

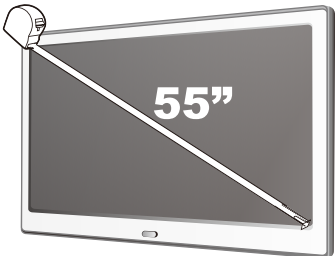

MAXIMUM SCREEN SIZE



MAXIMUM WEIGHT CAPACITY

USE WITH PRODUCTS LARGER THAN THE MAXIMUM WEIGHT AND SIZE MAY RESULT IN INSTABILITY CAUSING POSSIBLE INJURY. USER MUST REMOVE TELEVISION OR OBJECT OFF THE BRACKET BEFORE ADJUSTING. IF THE PRODUCT IS A TELEVISION MAXIMUM WEIGHT CAPACITY SUPERSEDES / OUTPLACES RECOMMENDED DIAGONAL MEASURED TELEVISION SIZE!!

STEP 2 Install TV bracket

Check TV screws

Please select the proper screw length for your TV by hand tightening to check your plat panel thread depth.

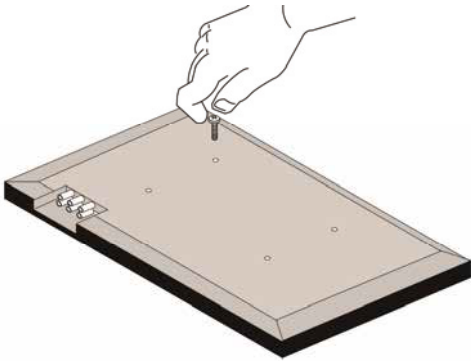

When attaching brackets to the flat screen, be careful not to over tighten screws and be sure that screws do not bottom out in the mounting holes.

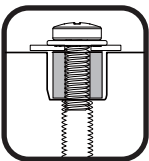

Too Short

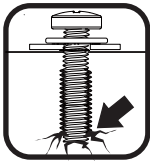

Too Long

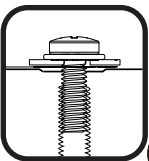

Correct

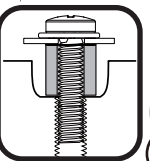

Correct

Tools Needed

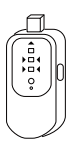

Stud Finder



Tape measure



Pencil

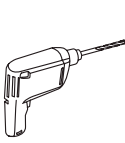

Drill



7/32 in.  
(5.5 mm)  
Wood Drill

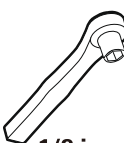

1/2 in.  
(12.7 mm)  
Screw driver



Screw driver



Hammer

Hardware Included

Wall Plates

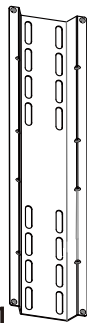

01 x1

Right TV Bracket



02 x1

Left TV Bracket



03 x1

Hardware (Wall / Procdut)

Lag Bolts



x4

A

Washers



x4

B

TV Screws / Washers

Philips Screws  
M4 x 12mm  
M4 x 30mm

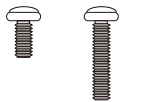

x4 x4

M-C M-D

Philips Screws  
M6 x 15mm  
M6 x 30mm

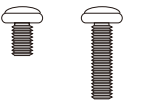

x4 x4

M-E M-F

Philips Screws  
M8 x 15mm  
M8 x 30mm

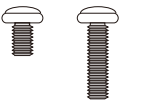

x4 x4

M-G M-H

Spacers  
L10mm



x4

M-I

Washers  
Ø6mm  
M4-6



x4

M-J

Spacers  
L5mm

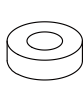

x8

M-K

STEP 2A FLAT BACK TV (UNIVERSAL MONITOR PLATE)

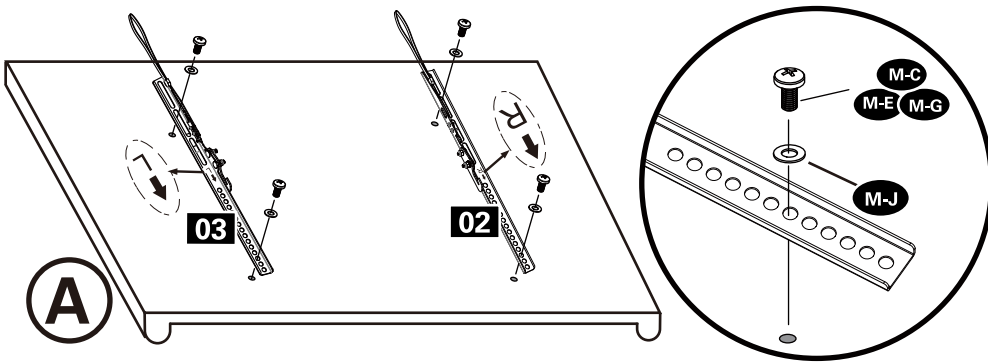

STEP 2B ROUND BACK TV (UNIVERSAL MONITOR PLATE)

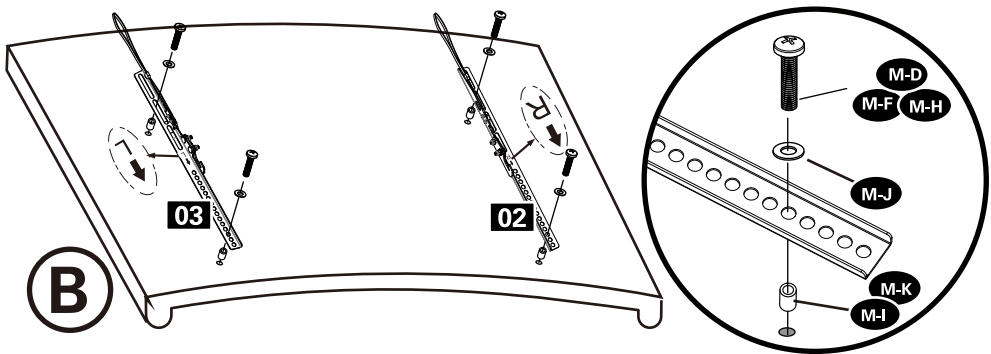

## STEP 3 Wall Plate Install

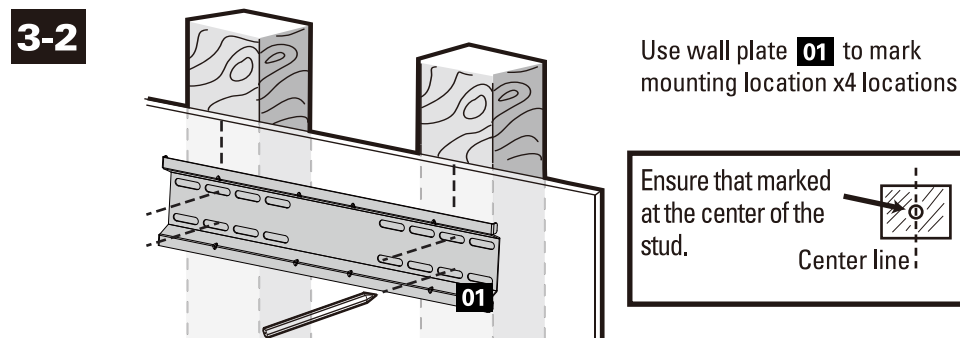
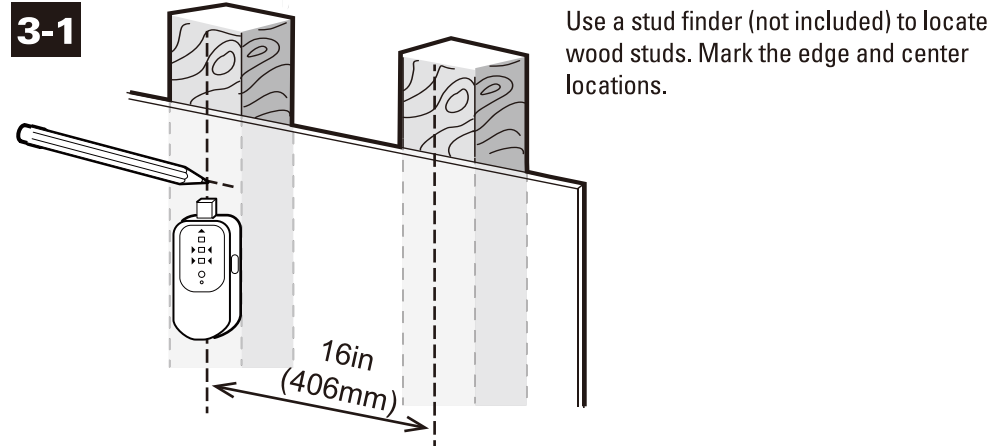

6

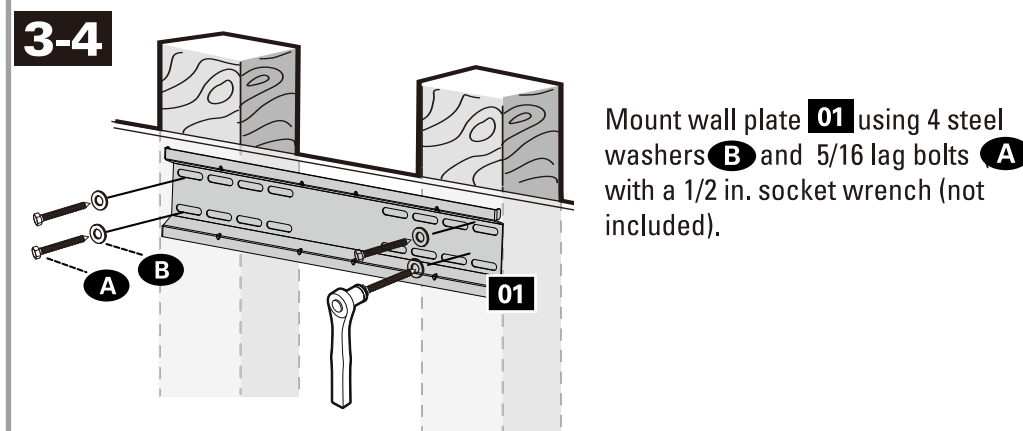
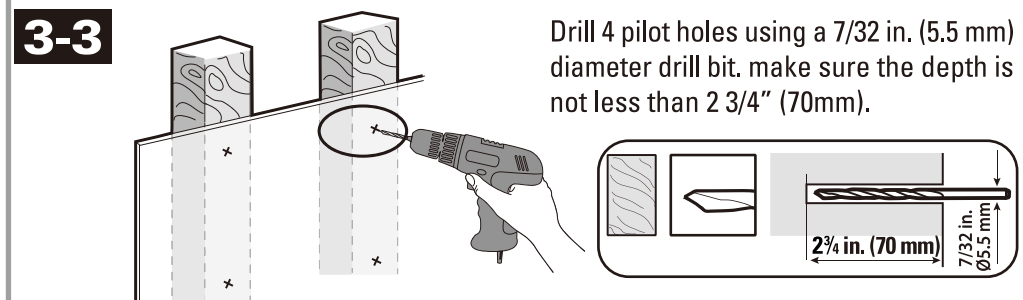

**CAUTION:** Ensure the wall plate is securely fastened to the wall before continuing on to the next step.

7

## STEP 4 Tighten Nuts

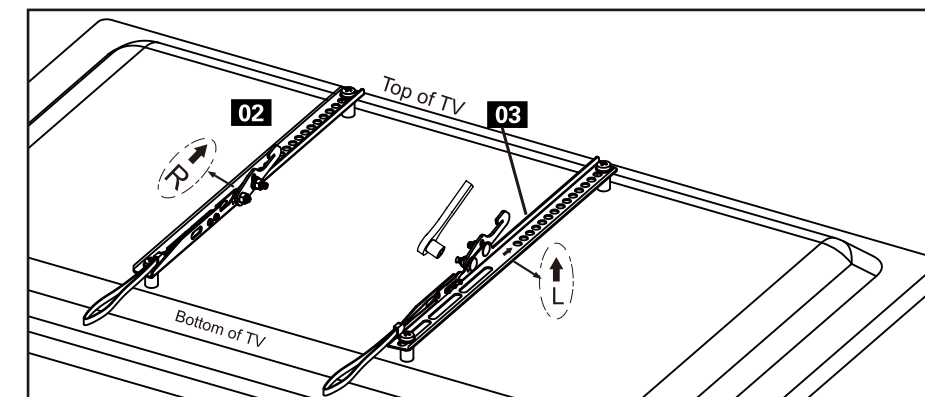

Adjust the tilting angle with the Screw driver for both for both **02** and **03**.

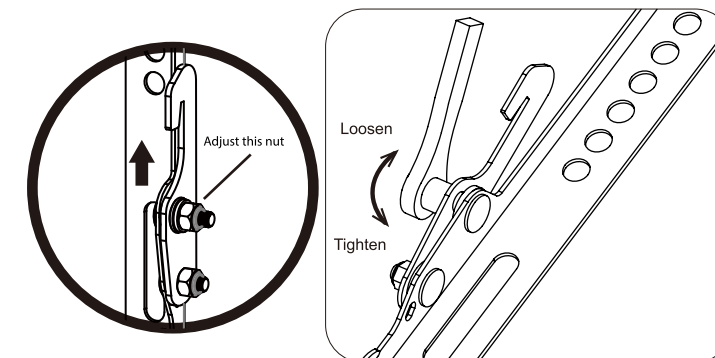

8

## STEP 5 Hang TV

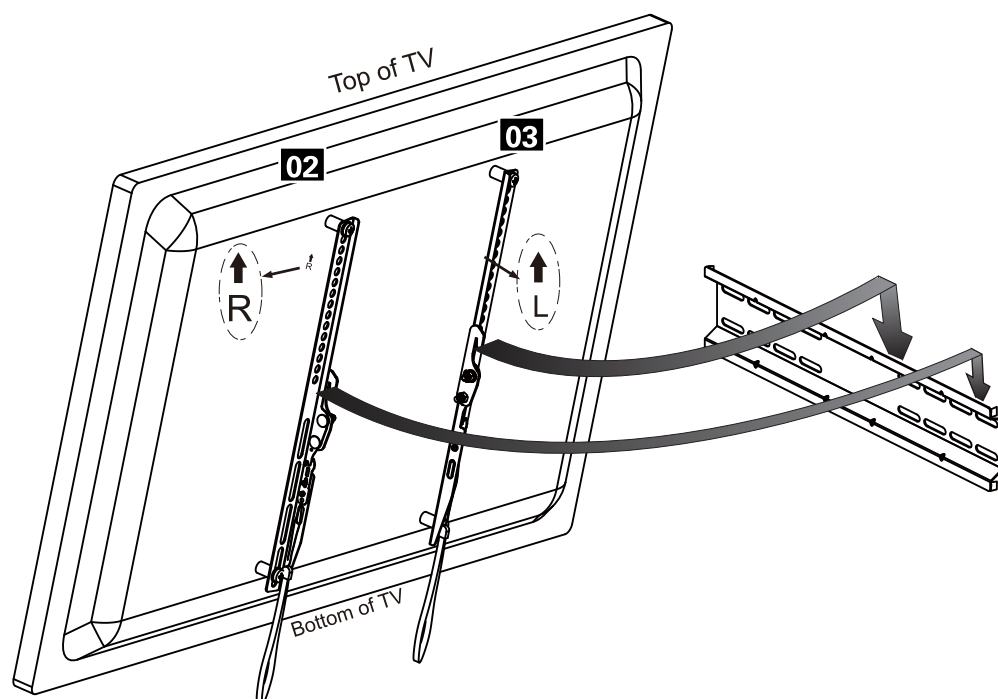

9

## STEP 6 Secure TV

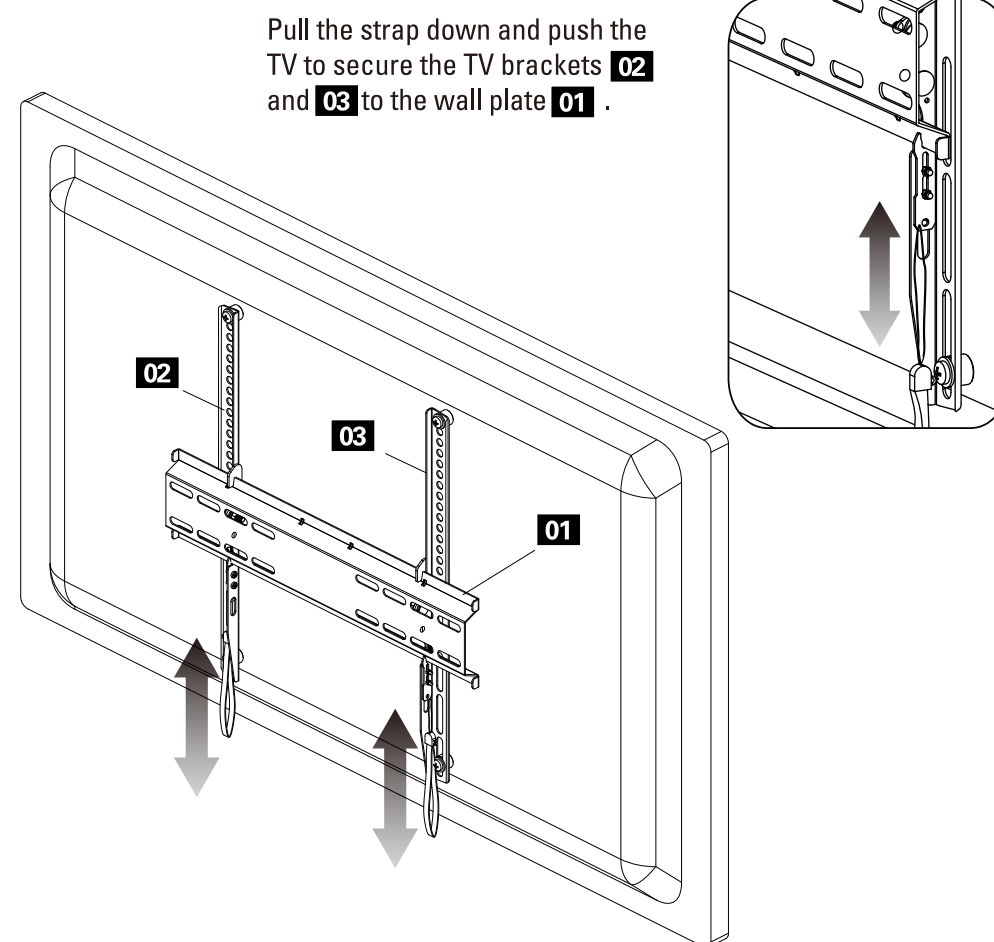

10



For any parts enquiries, please contact AV Supply Group as below:  
New Zealand: P 64 9 274 9172 E [info@avsupply.co.nz](mailto:info@avsupply.co.nz)  
Australia: P 61 3 9071 4585 E [info@avsupplygroup.com.au](mailto:info@avsupplygroup.com.au)

11